



# Looking after your new Nulook Windows and Doors

Your care and maintenance guide

# Welcome to your new home. We hope you find it a great place to live.

Nulook wants to help make your home a great place to live, with windows and doors that provide you with a perfect blend of form and functionality.

They look good, and work well, providing you with effortless opening and closing, ventilation as well as a lovely sense of light and space.

Your Nulook windows and doors are made to last. Wind, rain and sunlight will, however, take their toll over the years. To ensure your aluminium joinery continues to look great and work well into the future, you'll need to do some light cleaning and maintenance from time to time.

The harsher the environment (eg. near the sea or in high wind and rain zones), the more regular that maintenance will need to be.

This Guide provides you with useful tips around cleaning and maintenance. It's not designed to be a detailed Maintenance Manual or as a Warranty. It is recommended that the homeowner refer to the supplier care and maintenance guide for relevant information on the hardware, powder coat finish and performance of the glass installed in your home.

We strongly recommend that you access more detailed information around care and maintenance from relevant industry groups and suppliers.

To help you source this information, we've provided a checklist below.

[www.wanz.co.nz](http://www.wanz.co.nz)

[www.ganz.co.nz](http://www.ganz.co.nz)

[www.assaabloy.co.nz](http://www.assaabloy.co.nz)

[www.doric.com.au](http://www.doric.com.au)

[www.allegion.co.nz](http://www.allegion.co.nz)

[www.interpon.co.nz](http://www.interpon.co.nz)

[www.metroglasstech.co.nz](http://www.metroglasstech.co.nz)

[www.viridianglass.co.nz](http://www.viridianglass.co.nz)



If major repairs or maintenance is required (either to the framing or the glass), or you have queries around your product warranty, please contact your nearest Nulook fabricator on **0508 800 755** or email **info@nulook.co.nz**

# Tips to keep your windows and doors operating smoothly.

**Your Nulook windows and doors are designed to open and close smoothly and without fuss. You can ensure this smooth operation continues for years to come simply by following these easy steps.**

- Make sure you run your vacuum along the sills and tracks regularly to remove any dirt and grime. It's also a good idea to do this before you wash your windows and doors.
- Check that the drainage holes are clear (you'll find these holes outside the window or door in the bottom of the frame). You can clear away any dirt and obstructions with a small, soft bottle brush. Please note that if your window is "stacked", there may be small drainage holes between units or behind the track.
- It's important that all of the moving parts in your hardware components, tracks and rollers (if accessible) are regularly lubricated. We'd advise to do this once every two months. You can do this with a Teflon-based lubricant. If, however, your home is near the sea or exposed to salt air, we recommend that you lubricate the components once every four weeks.
- Check the weatherstripping around your window and door panels to make sure it is sealing evenly. If it looks like there are some gaps, we recommend that you contact your local Nulook fabricator on 0508 800 755.
- The seals and rubbers around the glass will need to be replaced from time to time depending on the environment. As a general rule, they should last for ten years or more. Replacing them is quite straightforward and can be done easily by a window/door maintenance service company.
- You may need to adjust your sliding door rollers to achieve proper height clearances. Most door rollers can be adjusted by using a screwdriver – there are access holes at both ends of the bottom of the sliding panel. When you're adjusting the roller, please ensure you lever the panel up so that there isn't any weight on the roller. When you've made roller adjustments, you may need to adjust the lock strike placement slightly, as follows.

## Sliding Door (Strike Plate Adjustment)

You can adjust the strike plate by following these simple steps. They relate to the surface mounted sliding door lock and the strike plate: (Picture A)

- Firstly, check the lock is operating correctly.
- Difficulty in operating may result from the anti-slam pin not being fully depressed while the door is in the closed position.
- To correct, open and loosen the strike plate retaining the screws (B) by one turn.
- Carefully loosen the anti-rattle screw (C) until the strike plate is no longer free to move.
- Note: care must be taken making these adjustments as excessive force may bend the strike plate.
- Check the lock operation and repeat if necessary.
- Rescrew the strike plate.

## Sliding Door (Roller Adjustment)

Insert a screwdriver as shown and engage screw to adjust the roller height. (Picture B)

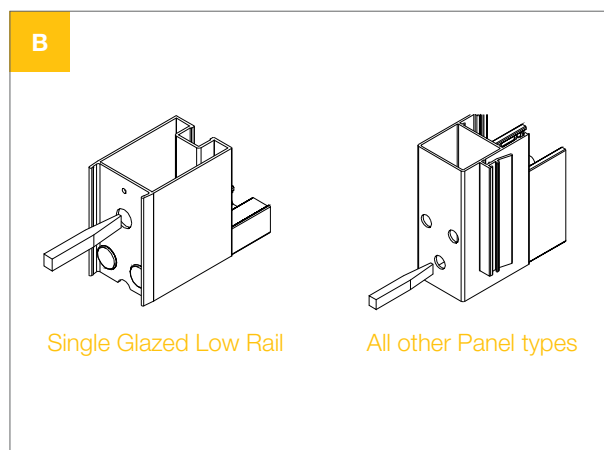
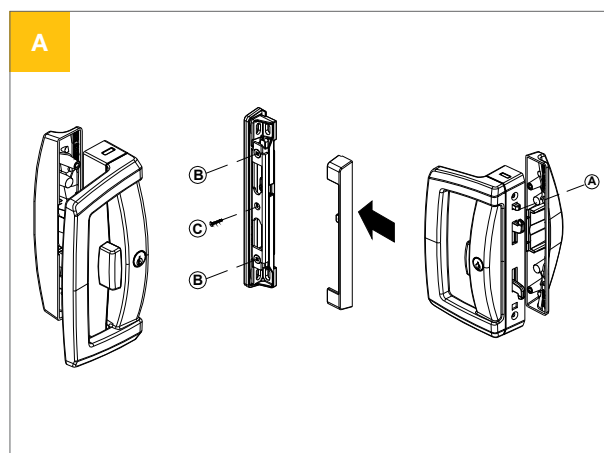



# Good looks that last, with just a little bit of help from you.

## Washing glass

Washing and drying the glass on your windows and doors every three to six months will keep those views looking crisp and clear.

Here are some simple steps to follow.

1. First, you'll need to loosen dirt and debris. Do this by soaking the glass surface with either warm water mixed with a mild soap detergent (such as dishwashing liquid) or a recognised glass cleaner.
2. After washing, rinse the glass with clean water and then dry it off with a clean, grit-free squeegee, cloth or paper towel.
3. Make sure that any water or cleaning solution residue is dried off the window gaskets, sealants and frames. This will prevent water spots.
4. Clean double glazed or laminated glass following the same steps as shown above for normal glass. Please make sure, however, that no solvent comes into contact with the edge laminate interlayer or the unit sealant.
5. Check that the frame drainage isn't blocked.
6. Be extra careful when you're washing reflective or Low E coated surfaces. Make sure you always follow the manufacturer's instructions. If you're unsure about these, refer to the second page for glass supplier website details. It is recommended that you read the information provided on glass quality from the supplier.

## Cleaning tinted and reflective glass

Avoid cleaning tinted or reflective glass surfaces in direct sunlight (so early in the morning, late in the afternoon or even early evening are the best times).

## Taking care of powder coated frames

You can wash the powder coated frames of your windows or doors with warm water and a mild detergent. DO NOT use a strong solvent cleaner as this will be harmful to the powder coating.

- If the powder coated surface has lost its gloss or is looking chalky, apply a high quality cream polish to the frame using a soft cloth. We strongly recommend that you read the manufacturer's instructions before you do this (contact your nearest Nulook fabricator if you're not sure). Avoid polishes that contain cutting compounds, again a Nulook fabricator in your region will be able to advise you on the best products to use.
- Powder coating on frames that are in sheltered areas will be more at risk of coating degradation. This is because wind-blown salt, grit and grime will stick to the surface. We recommend, therefore, that you check and clean window and door frames in these areas on a more regular basis





## Maintenance of anodised joinery frames

Anodising provides a tough, hard-wearing finish to your aluminium window and door frames. Some deterioration could occur over the years. This can be caused by grime building up on the frame, which in turn will trap moisture that can etch away at the anodised surface.

Regular cleaning will prevent build-up of grime and keep your joinery looking great for years. It's much like cleaning your car.

- Wash the aluminium with warm water and a suitable wetting agent or mild soap detergent. Use a sponge or a cloth. If you need to loosen dirt or grime, you can use a fine brush, but avoid using anything stiffer or more abrasive as you could end up damaging the surface. DO NOT use acid or alkali cleaners. These will damage the surface and could even discolour the joinery.
- You can clean away greasy deposits or really hard to remove grime by using a soft cloth dipped in white spirit, turpentine, kerosene or a mild liquid scourer. Make sure however that these solvents don't come into contact with any other parts of the window or door (including the rubber seal around the glass), as they will damage them. Remember to use a rag to dry off the joinery immediately after cleaning.
- You can provide extra protection for your anodised joinery by cleaning it with a good quality car wax after each wash. This will also lift the appearance of your joinery and keep it looking better, longer.

### Important Point

After cleaning, rinse anodised joinery thoroughly with lots of clean water and then dry the glass to prevent water spots.

## How often should anodised joinery be cleaned?

- Rural environments – every six months.
- Urban environments – every three months.
- Industrial and marine environments (or places that are exposed to a lot of salt and sulphur in the air) – every six months, as well as a cold water wash every month.





# Care and maintenance of your window and door hardware.

**General periodic care and maintenance is required on all hardware to ensure they continue to function correctly and maintain their appearance.**

It's important that you clean any harmful residue (such as salt sea spray) from the surface of your hardware to keep it looking good for years to come.

Before doing any cleaning or maintenance, you must establish exactly what hardware has been installed on your external windows and doors. It may be that the hardware used has come from more than one supplier. As a result, it may be constructed differently or made of different materials.

## Cleaning

### Powder Coated Hardware

1. Remove loose dirt with a wet sponge.
2. Using a soft brush or cloth and soap or mild domestic detergent in warm water, clean any dust, salt or other deposits from the hardware surface.
3. Thoroughly rinse with fresh water after cleaning to remove any remaining soap/detergent.

If you want to repair any weathered, blemished or scratched powder coat areas, please contact your local Nulook fabricator.

### Plated Hardware

Plated hardware requires special care. It's important that you remember the following points.

- Clean with a soft damp cloth or dry duster.
- Do NOT use abrasive cleaners, scourers or rough cloths.
- Do NOT use detergent or chemical cleaners
- When cleaning windows, don't use spray window cleaners as there is a risk that some of the spray will land on the plated hardware.
- If you are painting, varnishing or plastering, remember to protect or cover the plated surfaces.





### Stainless Steel Hardware

- Clean regularly using detergent and warm water. Rinse with fresh water and thoroughly dry the surface.
- Clean away any stains and discolouration with citric or nitric acid-based cleaners or a mild abrasive detergent. Rinse with fresh water and dry.
- Do NOT clean with wire wool or wire brushes as these will leave iron deposits that will rust.
- Do NOT allow salt deposits to build up on stainless steel product.
- Stainless steel is not stain proof - tea staining and other marks may appear.

NOTE: Avoid mechanical abrasives, hard water (deposits) and cleaners containing chlorides as they break down stainless steel's passivity layer and allows corrosion to occur.

## Maintenance

### Lubrication for Mechanisms

Mechanisms include friction slays, hinges, cylinders, mortise locks, rollers and fasteners. You can keep these mechanisms in good working order through regular cleaning and lubrication. We recommend a Teflon-based lubricate or please refer to the manufacturer's care instructions.

A soft bristle brush can be used on exposed parts. Apply Teflon-based lubricate to the moving parts – you don't need to use very much. This will limit corrosion of the exposed metals.

### Electrical Entrance Systems

Do not let the product get wet.

- Keep clear of debris and general dirt.
- Wipe the keypads or swipe the device with a clean damp cloth.
- Do NOT use solvents.
- Replacement batteries will be required.

NOTE: If you have any doubt or are unsure about the cleaning method it is recommended that you contact your nearest Nulook fabricator and hardware manufacturer.

### Sash Handles

When opening and closing your sash or awning windows, make sure that the lever is fully in the correct position as shown in the picture below before you push the window open or pull it closed. That way, you'll avoid any damage caused by the hardware and rubber hitting the joinery.

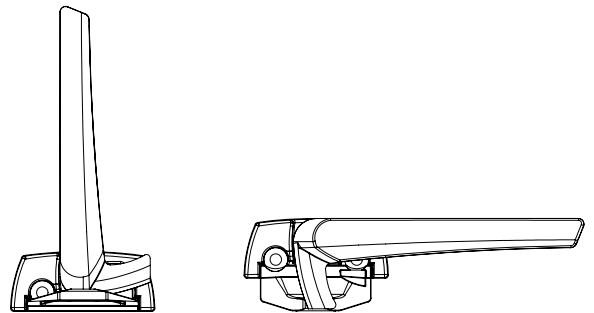

**Nulook Northland**

19 Clark Road, Kamo  
WHANGAREI 0112  
Tel: 09-435 0038 Fax: 09-435 0069  
Email: sales@nulooknorthland.co.nz

**Nulook North**

62 Forge Road, Silverdale  
AUCKLAND 0932  
Tel: 09-426 7042 Fax: 09-426 7041  
Email: windows@paradise.net.nz

**Nulook North Harbour**

158 Bush Road, Albany  
AUCKLAND 0632  
Tel: 09-448 1575  
Email: sales@nulooknorthharbour.co.nz

**Nulook Kumeu**

12 Loft Place, Kumeu  
AUCKLAND 0618  
Tel: 09-412 8569 Fax: 09-412 7439  
Email: stuart@nulookkumeu.co.nz

**Nulook Henderson**

16B Keeling Road, Henderson  
AUCKLAND 0612  
Tel: 09-837 3491 Fax: 09-837 3492  
Email: hulme@xtra.co.nz

**Nulook Central**

11A George Terrace, Onehanga  
AUCKLAND 1061  
Tel: 09-320 3872 Fax: 09-320 3596  
Email: sales@nulookcentral.co.nz

**Nulook East**

Unit G, 154-160 Harris Road, East Tamaki,  
AUCKLAND 2013  
Tel: 09-272 8186 Fax: 09-273 9764  
Email: nulooket@outlook.com

**Nulook Windows 2000**

52 Tidal Road, Mangere South  
AUCKLAND 2022  
Tel: 09-275 1575 Fax: 09-275 1586  
Email: info@win2000.co.nz

**Nulook Royale**

34 Creek Street, Drury  
AUCKLAND 2113  
Tel: 0800-769-253 Fax: 09-281-3480  
Email: joe@nulookroyale.co.nz

**Nulook Huntly**

402 Great South Road  
HUNTLY 3700  
Tel: 07-828 9091 Fax: 07-828 9036  
Email: nulookhuntly@xtra.co.nz

**Nulook Cambridge**

18 Oliver Street  
CAMBRIDGE 3434  
Tel: 07-827 8367 Fax: 07-827 3897  
Email: cambridge\_all@xtra.co.nz

**Nulook Gateway - Tokoroa**

11 Spence Street  
TOKOROA 3420  
Tel: 07-886 4297 Fax: 07-886 4298  
Email: tokoroa@gatewayglass.co.nz

**Nulook Waikato**

25 Waihou Street  
MATAMATA 3400  
Tel: 07-888 4221 Fax: 07-888 5559  
Email: darwin@nulookwaikato.co.nz

**Nulook Te Aroha**

28 Lawrance Avenue  
TE AROHA 3320  
Tel: 07-884 8389 Fax: 07-884 8379  
Email: nulooktearoha@xtra.co.nz

**Nulook Creations**

66 Birch Avenue, Judea  
TAURANGA 3110  
Tel: 07-578 3917 Fax: 07-578 1429  
Email: office@nulookcreations.co.nz

**Nulook Te Puke**

210 Jellicoe Street  
TE PUKE 3119  
Tel: 07-573 7415 Fax: 07-573 7415  
Email: nulooktepuke@clear.net.nz

**Nulook Gateway - Rotorua**

31-34 Allen Mills Road, Ngapuna,  
ROTORUA 3010  
Tel: 07-345 7816 Fax: 07-345 7816  
Email: nulook.rotorua@gatewayglass.co.nz

**Nulook New Plymouth**

10 Cygnet Drive (off Corbett Rd), Bell Block  
NEW PLYMOUTH 4373  
Tel: 06-755 4176 Fax: 06-755 4179  
Email: office.nulooknp@xtra.co.nz

**Wairoa Building Supplies Ltd**

159 Carrol Street  
WAIROA 4108  
Tel: 06-838 7332 Fax: 06-838 3303  
Email: waibldsup@xtra.co.nz

**Nulook CHB**

16 Peel Street  
WAIPUKURAU 4200  
Tel: 06-858 8578 Fax: 06-858 8531  
Email: nulook@xtra.co.nz

**Nulook Levin**

5 Totara Street  
LEVIN 5510  
Tel: 06-368 3523 Fax: 06-368 4823  
Email: nulooklevin@vodafone.co.nz

274 Rangitikei Street  
PALMERSTON NORTH 4410  
Tel: 06-359 3893 Fax: 06-359 3883  
Email: nulook@vodafone.co.nz

**Nulook Wanganui**

4 Pacific Place, Gonville  
WANGANUI 4500  
Tel: 06-345 2375 Fax: 06-345 6041  
Email: nulook.wanganui@xtra.co.nz

**Nulook Kapiti**

131 Makarini St  
PARAPARAUMU 5032  
Tel: 04-298 7091 Fax: 04-298 7715  
Email: nulook-kapiti@xtra.co.nz

**Capital Nulook**

53 Montgomery Crescent, Clouston Park  
UPPER HUTT 5018  
Tel: 04-526 9933 Fax: 04-526 7856  
Email: cwad@ihug.co.nz

**Nulook Tasman Bay**

20a Old Wharf Road  
MOTUEKA 7120  
Tel: 03-528 9057 Fax: 03-528 9051  
Email: aaron@nulooktasmanbay.co.nz

**Nulook Solutions - Nelson**

16 Nayland Road, Stoke  
NELSON 7011  
Tel: 03-538 0100 Fax: 03-538 0609  
Email: stephen.scott@nulooksolutions.co.nz

**Nulook Blenheim**

41 Houldsworth Street  
BLENHEIM 7201  
Tel: 03-578 3049 Fax: 03-578 0161  
Email: wesley@blenheimitm.co.nz

**Nulook Sotherans**

Cnr Leonard and Herbert Streets  
GREYMOUTH 7805  
Tel: 03-768 7643 Fax: 03-768 7630  
Email: sotherans@xtra.co.nz

**Bates Aluminium Ltd**

101 Shortland Street, Wainoni  
CHRISTCHURCH 8061  
Tel: 03-388 8027 Fax: 03-388 6240  
Email: mitch@batesaluminium.co.nz

**Nulook Canterbury**

11 Henry Street, Waltham  
CHRISTCHURCH 8011  
Tel: 03-389 6466 Fax: 03-389 6076  
Email: nulook@paradise.net.nz

**Nulook Solutions - Christchurch**

Unit 11, 20 Dakota Crescent, Wigram  
CHRISTCHURCH 8042  
Tel: 03-343 8866  
Email: stephen.scott@nulooksolutions.co.nz

**Raylight Aluminium Ltd**

31 Disraeli Street, Addington  
CHRISTCHURCH 8024  
Tel: 03-366 5637 Fax: 03-366 1790  
Email: raylight@xtra.co.nz

**Nulook Morse**

67 Church Street  
TIMARU 7910  
Tel: 03-688 3062 Fax: 03-688 3061  
Email: morse-aluminium@xtra.co.nz

**Nulook Oamaru**

14 Humber Street  
OAMARU 9400  
Tel: 03-434 7161 Fax: 03-434 7161  
Email: office@nulookoamaru.co.nz

**Nulook Morlite**

307 Kaikorai Valley Road, Bradford  
DUNEDIN 9011  
Tel: 03-453 5980 Fax: 03-453 5369  
Email: sales@morlite.co.nz

**Nulook Abell**

21 Lyne Street  
GORE 9710  
Tel: 03-208 4737 Fax: 03-208 9747  
Email: abell.alum@gmail.com

**Nulook North End Joinery**

59 Essex Street  
BALCLUTHA 9230  
Tel: 03-418 1390 Fax: 03-418 1393  
Email: nej@ispnz.co.nz

**Nulook Wanaka**

7 Gordon Road  
WANAKA 9305  
Tel: 03-443 1390 Fax: 03-443 1392  
Email: wanaka.nulook@xtra.co.nz

**Nulook Otatau Joinery**

90 King Street  
OTAUTAU 9610  
Tel: 03-225 8381 Fax: 03-225 8953  
Email: otataujoinery@paradise.net.nz

**Nulook Southland**

22 Bay Road, Grasmere,  
INVERCARGILL 9810  
Tel: 03-215 9068 Fax: 03-215 9531  
Email: sam@nulooksouthland.co.nz